

Specimen Requirements & Logistics

Fulgent Genetics accepts various types of specimens. The information below will provide a guide for which type might be best for your situation.

Blood/Bone Marrow

- We accept two (2) 4ml in EDTA (lavender top) or ACD (yellow top) tubes, or one of each.
- For patients less than 1 year of age or bone marrow specimens, we can accept 1-2ml (minimum).
- This is our preferred specimen type to receive for testing. Blood specimens can be sent at ambient temperature. Express delivery is recommended such that the sample arrives at Fulgent within 72 hours from collection. Alternatively, blood tubes can also be sent refrigerated.

Extracted DNA

- DNA should be submitted in 1.5mL tubes individually labeled with 2 unique patient identifiers matching the test requisition form.
- Minimum amount of DNA per submission is 3µg eluted in EB Buffer or equivalent. DNA extracted from sources containing Heparin cannot be accepted due to the inhibitory effects of this anticoagulant. Any questionable sources should be confirmed for acceptance by the lab.
- A minimum volume of 30 µL or 0.030mL of DNA is highly recommended.
- DNA specimens can be sent at ambient temperature. Express delivery is recommended such that the sample arrives at Fulgent within 72 - 96 hours from sample pick up.
- DNA must be extracted from a CLIA-certified laboratory or a laboratory meeting equivalent requirements as determined by CAP and/or CMS.

Saliva / Buccal Swab

- Fulgent saliva collection kits or DNA Genotek OCD-100 kits (saliva swabs) are preferred and can be provided upon request.
- For del/dup analysis, blood samples are preferred as swab samples may fail to generate high quality data.
- Saliva / buccal swab specimens can be sent at ambient temperature. Express delivery is recommended such that the sample arrives at Fulgent within 72 - 96 hours from sample send-out.
- Proper specimen storage is important prior to sample send out. Review sample insert for details and minimize specimen exposure to excessive heat.
- [OCD-100 saliva swab collection instructions](#)

Prenatal Specimens

- We accept two (2) T-25 flasks of cultured cells; ~70% confluency is preferred.
- Please call to speak with a genetic counselor PRIOR to sending the sample to avoid delays in processing.
- If you require a Maternal Cell Contamination study then we will also need the mother's blood in addition to the T-25 flasks.
- Cultured cell specimens can be sent at ambient temperature. Express delivery is highly recommended such that the sample arrives at Fulgent within 72 - 96 hours from sample send-out. Additional refrigeration with the use of ice packs is also recommended during warmer weather.

Cultured Fibroblasts

- Cultured fibroblasts or DNA extracted from cultured fibroblasts should be submitted instead of blood/saliva/buccal samples from individuals who have undergone allogeneic bone marrow transplant and from patients with hematologic malignancy.
- We accept two (2) T-25 flasks of cultured cells; ~70% confluency is preferred.
- Fibroblasts are able to be cultured from skin punch biopsy or muscle biopsy.
- Cultured cell specimens can be sent at ambient temperature. Express delivery is highly recommended such that the sample arrives at Fulgent within 72 - 96 hours from sample send-out. Additional refrigeration with the use of ice packs is also recommended during warmer weather.
- Store T-25 flasks in a 37°C incubator prior to shipment.

Fresh / Frozen Tissue

- 1g of sample from any of the following sources: muscle, liver, spleen, skin, lung, or placenta (Maternal Cell Contamination study recommended for placenta samples).
- Brain tissue and specimens under 1g are not recommended; they are only accepted with special circumstances and approval from a Lab Director.
- It is highly recommended that fresh tissue samples are received within 24 to 48 hours after collection. Additional refrigeration during transit is further recommended during warmer weather.
- Frozen tissue samples must be stored at -80°C immediately after collection and shipped with dry ice.
- Tissue samples are very delicate and we will use our best efforts to extract quality DNA. However, the success of extraction cannot be guaranteed.

Patients who have undergone Blood Transfusions

- Recent packed cell/platelet transfusion or whole blood transfusion patients should wait at least 2-4 weeks prior blood draw for testing. If DNA quality is insufficient, additional sample will be requested.

Patients who have undergone a Bone Marrow Transplant or have a hematologic malignancy

- DNA extracted from cultured fibroblasts should be submitted instead of blood/saliva/buccal samples from individuals who have undergone allogeneic bone marrow transplant and from patients with hematologic malignancy.

KIT PREPARATION

Prepare collection kits for shipping in the following manner:

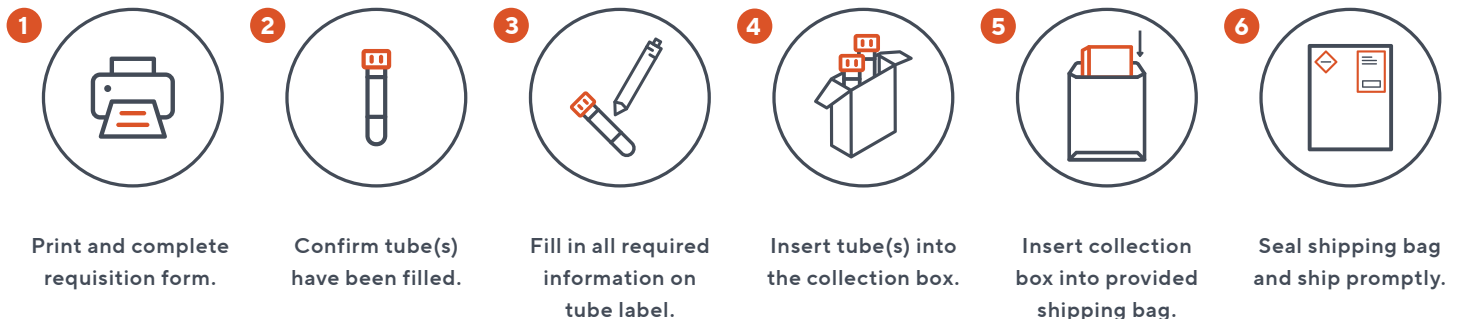

SHIPPING INSTRUCTIONS

Use the provided return shipping material or contact us for instructions:

Main Laboratory

Fulgent Genetics
4399 Santa Anita Avenue
El Monte, California 91731
United States of America

CONTACT

Have Questions?

Email info@fulgentgenetics.com

Phone +1 626.350.0537